

**IMPORTANT NOTE:**

THE LAYOUT AND LOCATION OF PLANTING AREAS, PARK EQUIPMENT (eg. PARK SHELTERS, PLAY EQUIPMENT ETC.) AND THE LIKE, FOR ALL PARK TYPES ARE SHOWN IN INDICATIVE TERMS ONLY AND WILL VARY AS A RESULT OF DETAILED DESIGN DEVELOPMENT.

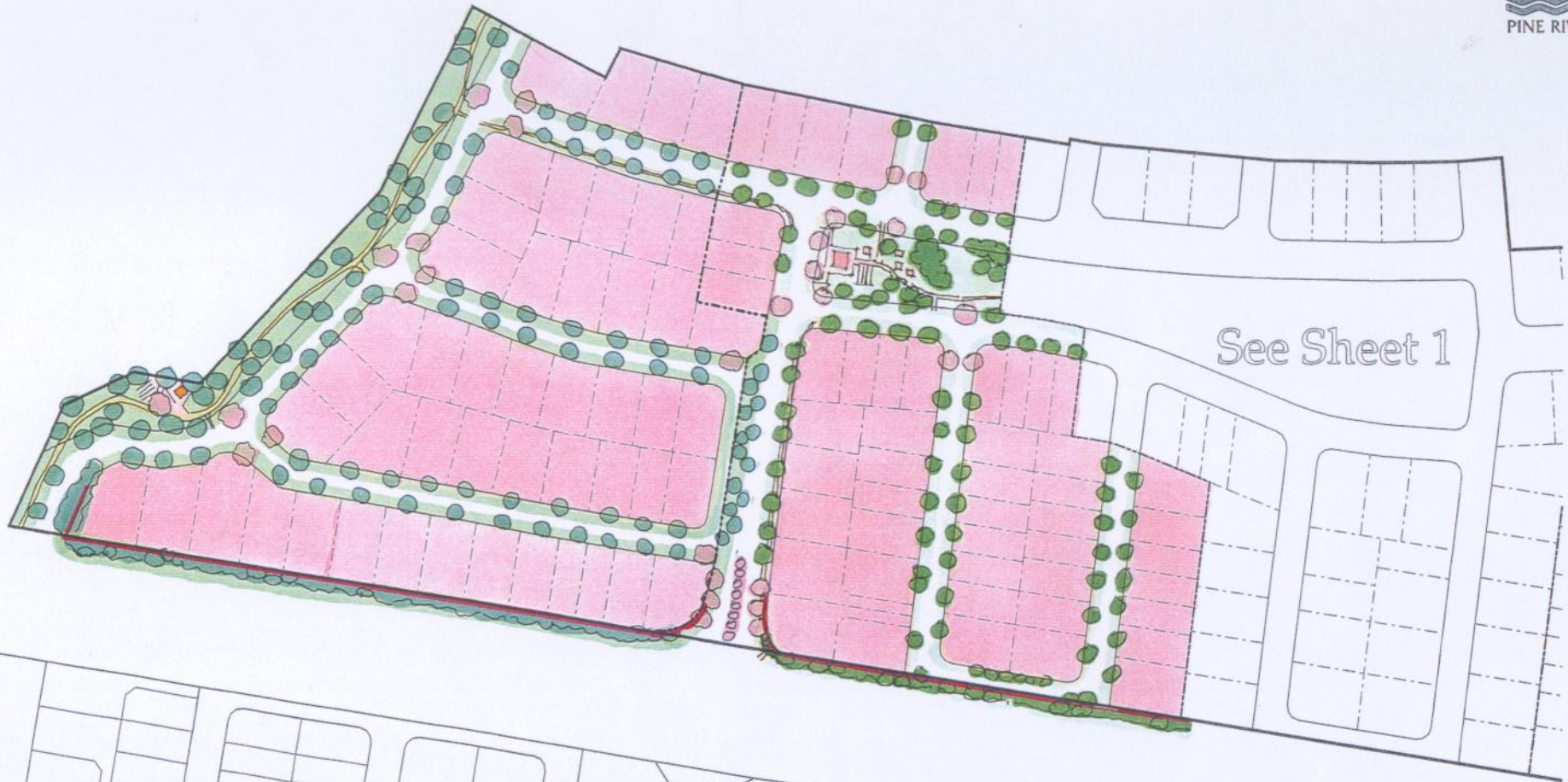

**STREETSCAPE PLANTING**

The final streetscape planting design is to make provision for appropriate street tree planting taking into account the image and role of the street in the road hierarchy, selection of appropriate species and services locations.

- Acceptable solutions for street tree planting include:-
- (i) Collector Streets - Street tree planting to be typically 7 to 10 metres high and selected predominantly from native species (eg Brachychiton, Syzygium, Flindersia)
  - (ii) Access Streets - Street tree planting to be typically 4 to 7 metres high and selected predominantly from native species (eg Melaleuca, Cupaniopsis, Xanthostemon)

Exotic and flowering species may only be used as special feature planting in the streetscape design, eg to announce road entries to the sector or to highlight intersections.

The preferred species of trees, shrubs and ground covers to be used in streets and parks within this sector are contained in the Plant List - refer Annexure B of the sector plan.

**LEGEND**

	<b>INFORMAL STREET TREE PLANTING</b>		<b>PLAYGROUNDS</b>		<b>ACOUSTIC FENCE AND SCREEN PLANTING</b>
	<b>FEATURE ACCENT PLANTING</b>		<b>INDICATIVE EXISTING TREES</b>		<b>SECTOR BOUNDARY</b>
	<b>PATHWAYS</b>		<b>PARKLAND PLANTING</b>		
	<b>PARK SHELTERS AND PICNIC NODES</b>		<b>OPEN SPACE</b>		

**CENTRAL EAST RESIDENTIAL PRECINCT  
RESIDENTIAL SECTOR SEVEN**

**SECTOR LANDSCAPE PLAN (PART B)**



Scale 1:2000 #AT A3

File No. F 2.5.14

Dgn No. CERP-RS7-F06 B Sheet 2 of 2

FEBRUARY 2001

**FIGURE 6 B**